

BETA

Faretto incasso a LED per illuminazione d'accento. Corpo in alluminio anodizzato o verniciato bianco RAL9010 con ghiera tonda. Diffusore di protezione in materiale plastico trasparente.

Round recessed spotlight with fixing clips. Body in anodized or painted aluminium (RAL9010). Aluminium frame in round shape. Clear protection glass and installation clips.



BETA	EN3020	EN3025	EN3027
LED Colour	White 3000K or 4000K	White 3000K or 4000K	White 3000K or 4000K
LED Number	1	1	1
TOTAL Power	1,2W	1,2W	1,2W
Input	350Wa	350Wa	350Wa
Weight	0,05 kg	0,05 kg	0,05 kg
Lens	-	-	-
Insulation Class	III	III	III
IP Code	IP40	IP40	IP67
Dimensions	Ø 37x25 mm	Ø 37x25 mm	Ø 37x25 mm
Recessed dimensions	Ø 25mm	Ø 25mm	Ø 25mm
Body finishing	AL anodized	AL anodized	AL anodized
Diffuser finishing	Clear	Matt	Matt

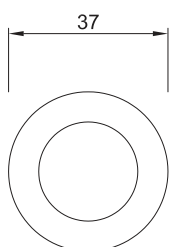
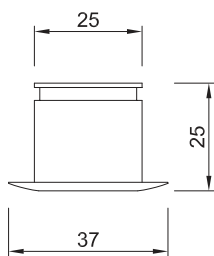

BETA slim

Faretto da incasso a led, corpo in acciaio inox diffusore di protezione in materiale plastico opaco. Grazie allo spessore molto ridotto è un apparecchio particolarmente adatto per installazione su parquet o controsoffitti molto bassi.

Led spot for recessed installation, suitable to an intensive lighting effects. Body in stainless steel. Opal diffuser. Suitable for parquet installation thanks to its short profile.



BETA SLIM	EN3017
LED number:	1x1,2 W
LED colour:	white
Lens:	-
Input Power:	350mA
IP code:	IP68
Insulation class:	III
Dimensions:	Ø 35 x 12 mm
Recessed dimension:	Ø 25 mm
Weight:	0,07 kg
Body finish:	stainless steel
Diffuser:	opal

